

# \$15,000 - 1230 Windermere Way, Edmonton

MLS® #E4442257

**\$15,000**

0 Bedroom, 0.00 Bathroom,  
Condo / Townhouse on 0.00 Acres

Windermere, Edmonton, AB

Parking stall only (#74). Can be included with the sale of Unit #110 - 1230 Windermere Way SW. Parking stall #74 is located right across from parking stall and storage unit #73 which is sold with Unit #110.

Built in 2011

## Essential Information

MLS® #	E4442257
Price	\$15,000
Bathrooms	0.00
Acres	0.00
Year Built	2011
Type	Condo / Townhouse
Sub-Type	Parking Stall
Status	Active

## Community Information

Address	1230 Windermere Way
Area	Edmonton
Subdivision	Windermere
City	Edmonton
County	ALBERTA
Province	AB
Postal Code	T6W 2J3

## Amenities

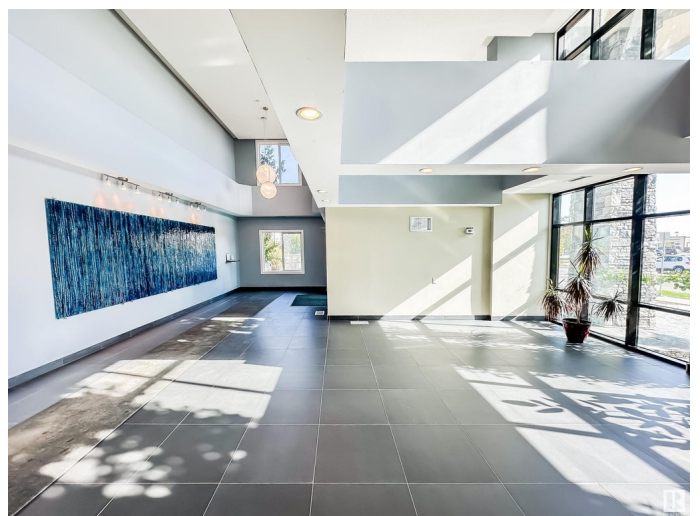

Parking Spaces 1  
Parking Heated, Parkade, Stall, Underground

## Exterior

Exterior Features See Remarks

## Additional Information

Date Listed June 13th, 2025  
Days on Market 3  
Zoning Zone 56  
Condo Fee \$21

DATA IS DEEMED RELIABLE BUT IS NOT GUARANTEED ACCURATE BY THE REALTORS<sup>®</sup> ASSOCIATION OF EDMONTON. COPYRIGHT 2025 BY THE REALTORS<sup>®</sup> ASSOCIATION OF EDMONTON. ALL RIGHTS RESERVED. Trademarks are owned or controlled by the Canadian Real Estate Association (CREA) and identify real estate professionals who are members of CREA (REALTOR<sup>®</sup>, REALTORS<sup>®</sup>) and/or the quality of services they provide (MLS<sup>®</sup>, Multiple Listing Service<sup>®</sup>)

Listing information last updated on June 16th, 2025 at 6:02am MDT